

Print then Cut Calibration

The Print then Cut feature of Cricut Design Space™ for PC and Mac® allows you to print your images from your home printer and then cut them out with high precision on your Cricut® machine. Print then Cut calibration is a series of simple cuts, questions, and answers designed to help your Cricut® machine cut exactly along the edge of your printed image.

- Cricut Explore Air™ machines are pre-calibrated.
- Cricut Explore® machines require calibration if using the Print then Cut feature for the first time; you will be prompted to calibrate when you start the cutting process. (If you've printed your project prior to calibration, set it aside - you'll be able to use it after calibration is complete.)

If you need to calibrate your machine for Print then Cut, you will be prompted to do so. You can also go through the calibration process at any time if you are experiencing any inaccuracies when cutting out printed images.

Follow these steps to initiate the process yourself: (If you are prompted to calibrate, start at step 2.)

Step 1 Once you have signed in with your Cricut ID, select “Calibration” from the Account menu.

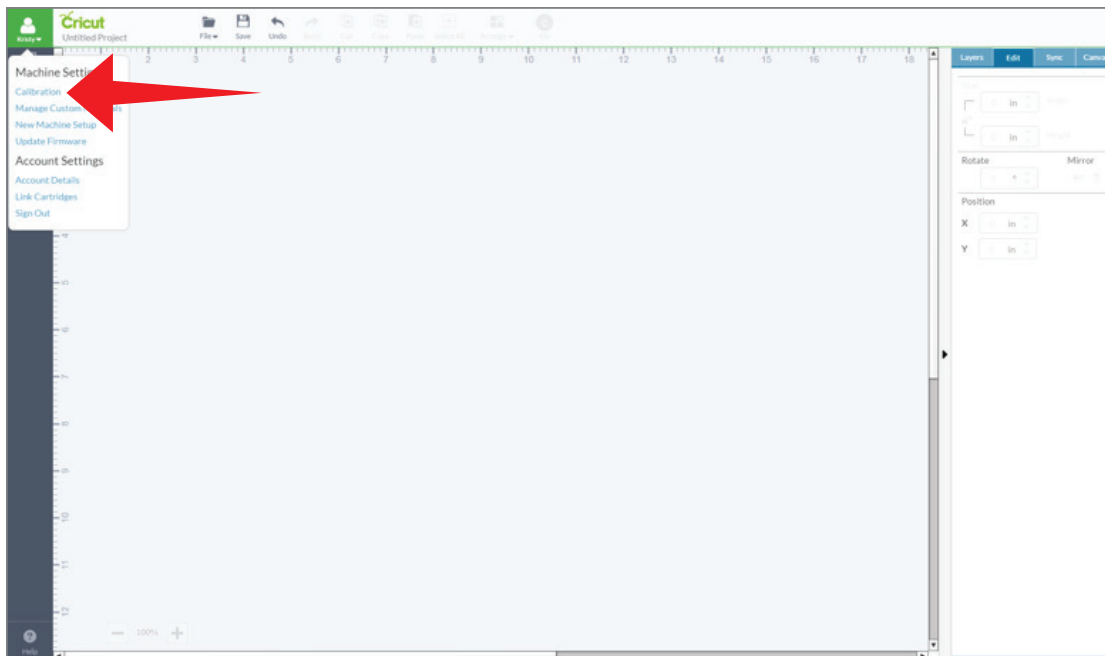

Print then Cut Calibration

Step 2 Click the Continue button to begin.

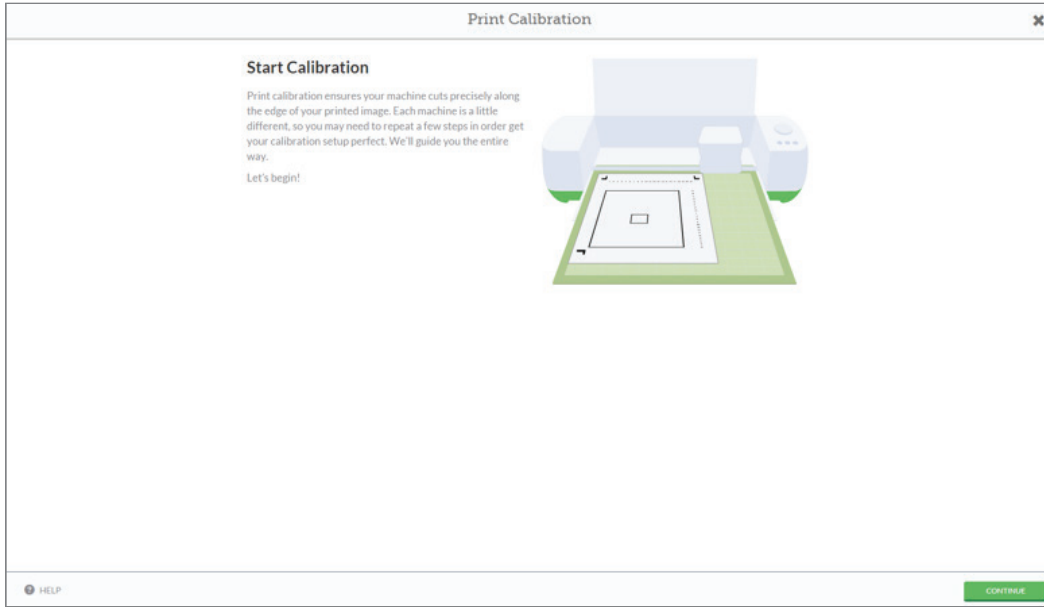

Step 3 Load white 8 1/2" x 11" paper into your printer for the calibration sheet and then click the Continue button.

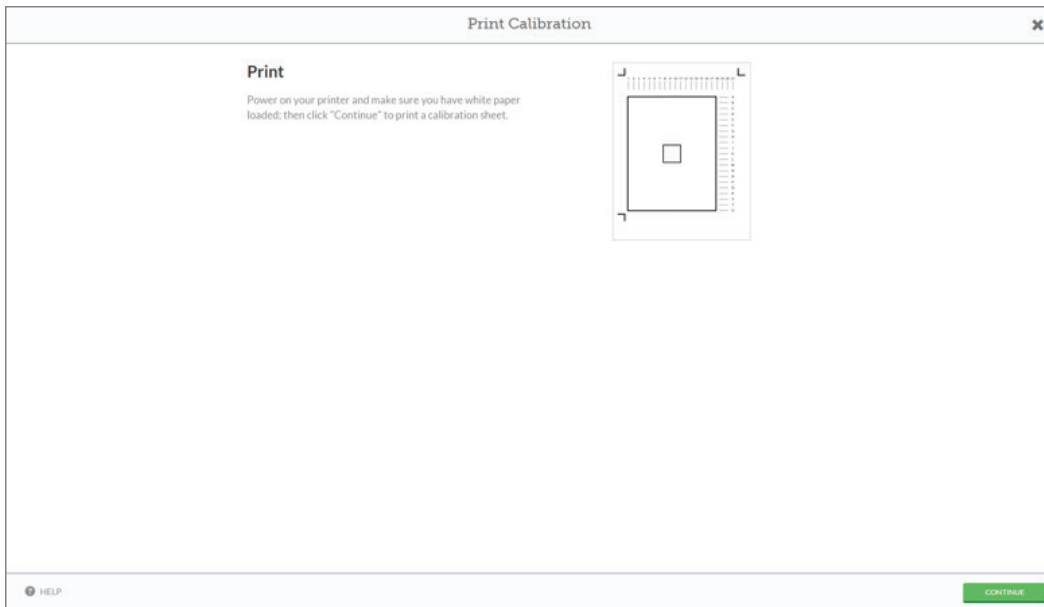

Tip: The Print then Cut feature should always be used with white materials. Colored materials may prevent your machine from accurately reading the cut sensor marks.

Print then Cut Calibration

Step 4 In the print dialogue box that appears, check that the destination is your printer and then click “Print.”

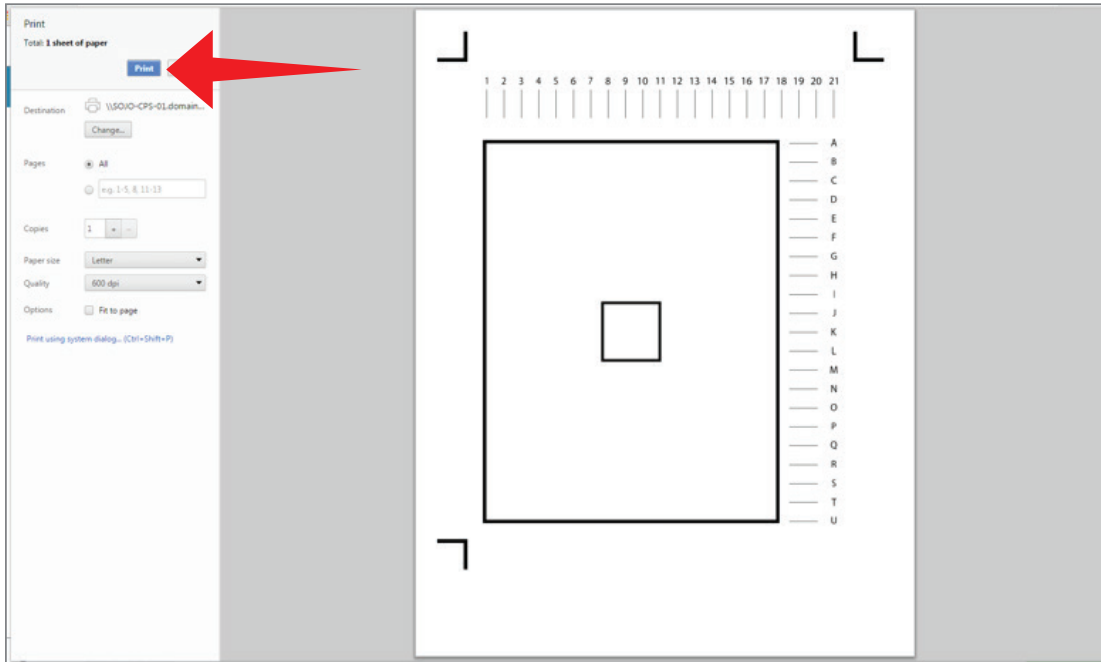

Tip: The look of the print dialog screen may differ based the type of computer you are using.

Step 5 Make sure your Cricut® machine is powered on and connected to your computer. Once your machine has been detected, place the printed calibration sheet on the cutting mat as indicated on the screen and load it into your Cricut® machine. Turn the Smart Set® dial to the Paper setting and then press “Go” on your machine.

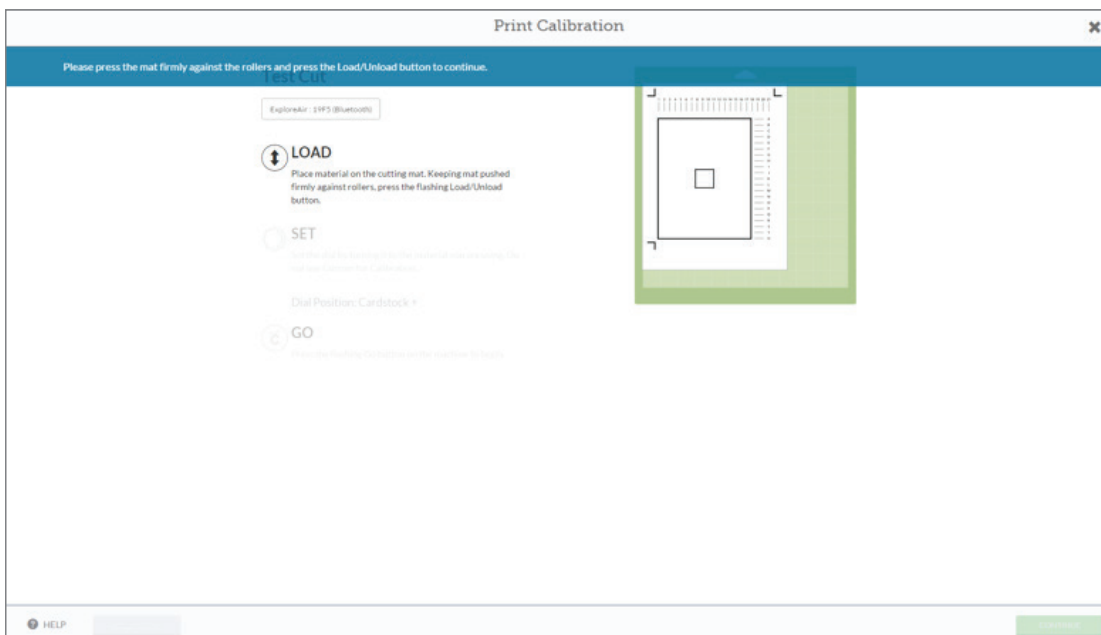

Print then Cut Calibration

Step 6 Your machine will detect the cut sensor marks around the images and then make a test cut around the small center square. When it is finished cutting, **DO NOT** unload the cutting mat. While the mat is still loaded into the machine, take a look at the cut lines around the small square in the middle.

- Click “Yes” and then “Continue” if the cut line touches the printed line all the way around the small box.
- Click “No” and then “Continue” if the cut line does not match up with the printed line around the small box. In order to get everything just right, you’ll walk through the same steps we covered here.

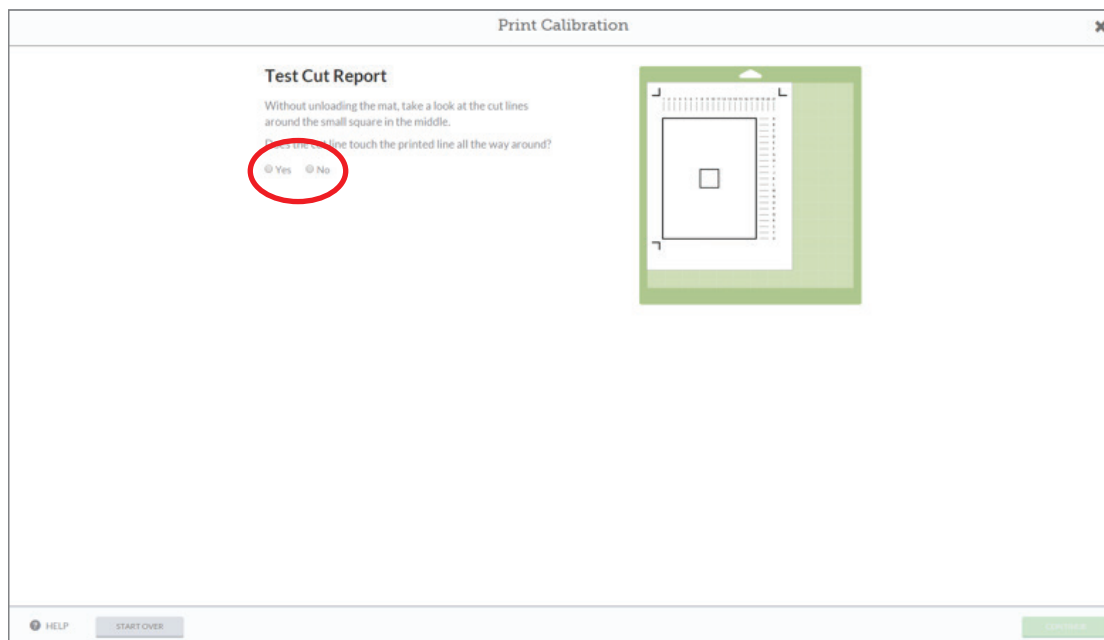

Print then Cut Calibration

Step 7 Your Cricut® machine will make a series of horizontal and vertical cuts on the calibration sheet. Once your machine is done cutting, **DO NOT** unload the cutting mat. Look at the lines on the top and along the right side of the test print page. Determine which cuts are centered on or closest to the print line.

Select the corresponding number or letter in the drop-down menus. Click “Continue” after you have made your selections.

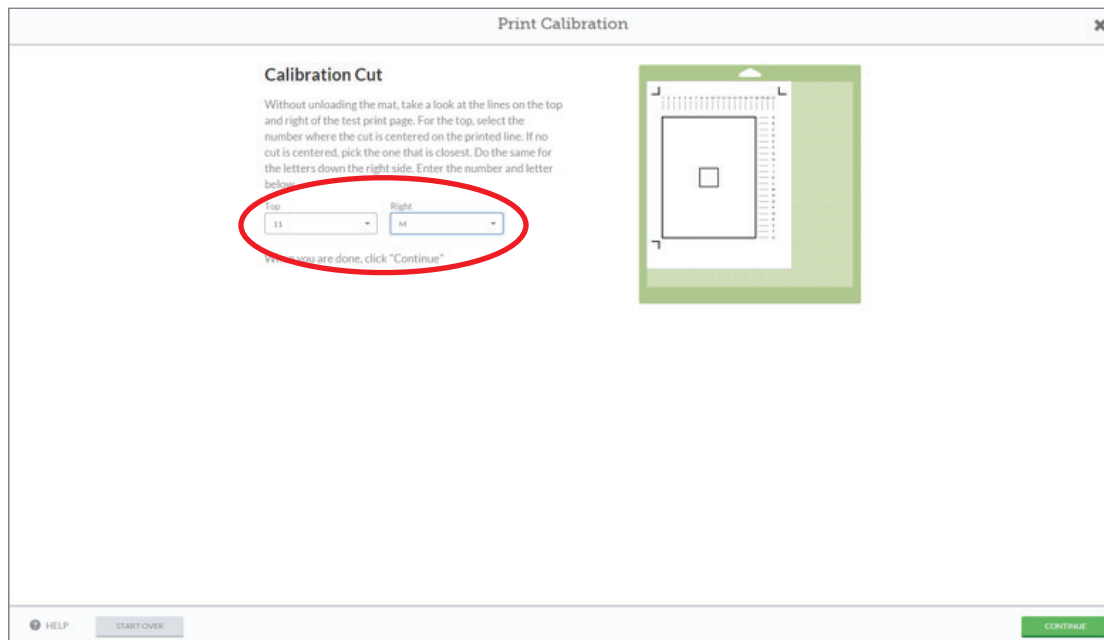

Print then Cut Calibration

Step 8 The machine will cut the larger rectangle. When it is finished cutting examine the cut line.

- Click “Yes” and then “Continue” if you are satisfied with the accuracy of the large box cut.
- Click “No” and then “Continue” if you feel the cut could be improved. You’ll be prompted to repeat the process to improve the calibration of your machine.

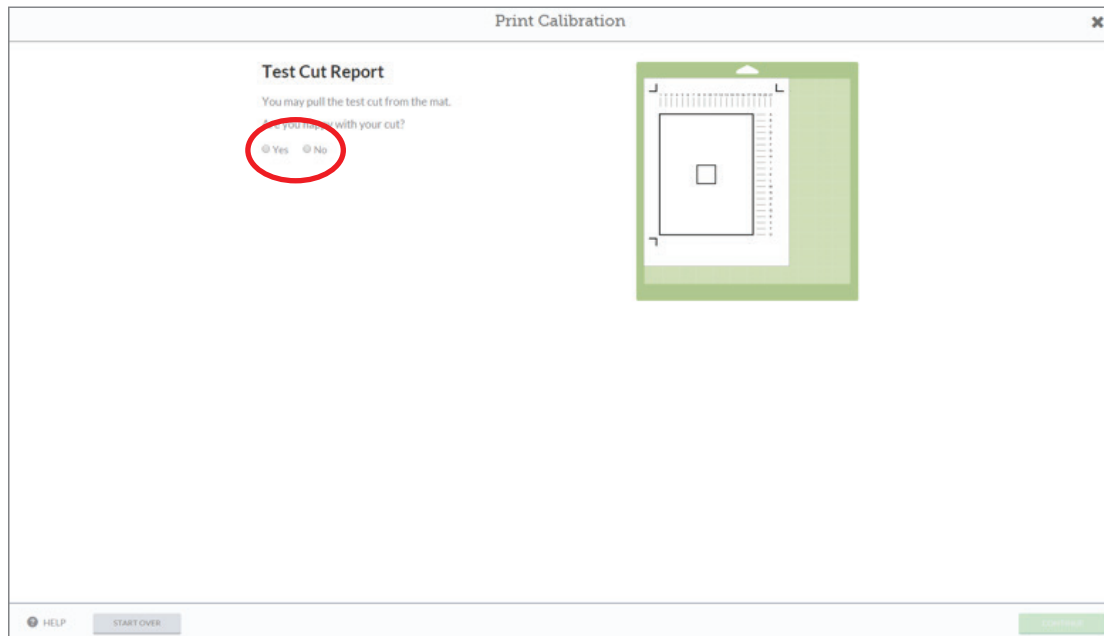

Step 9 You’re done! Your machine is calibrated; simply click “Save and Close” to proceed.

